

Rear door window

Tools

Special tools, testers and auxiliary items required

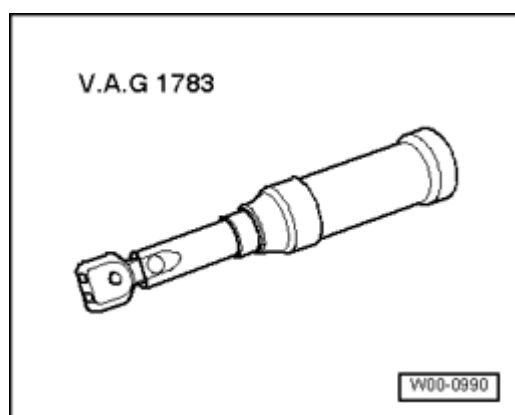

- Torque wrench 210 Nm V.A.G 1783

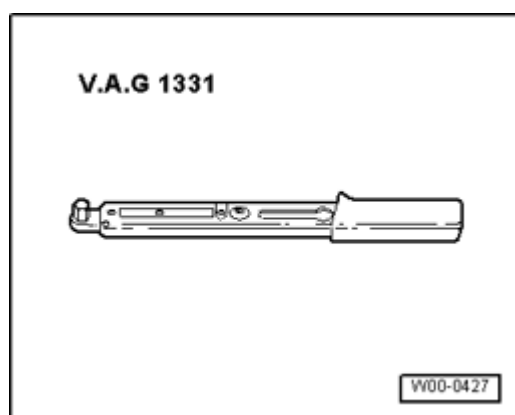

- Torque wrench V.A.G 1331 (550 Nm)

Rear door, assembly overview

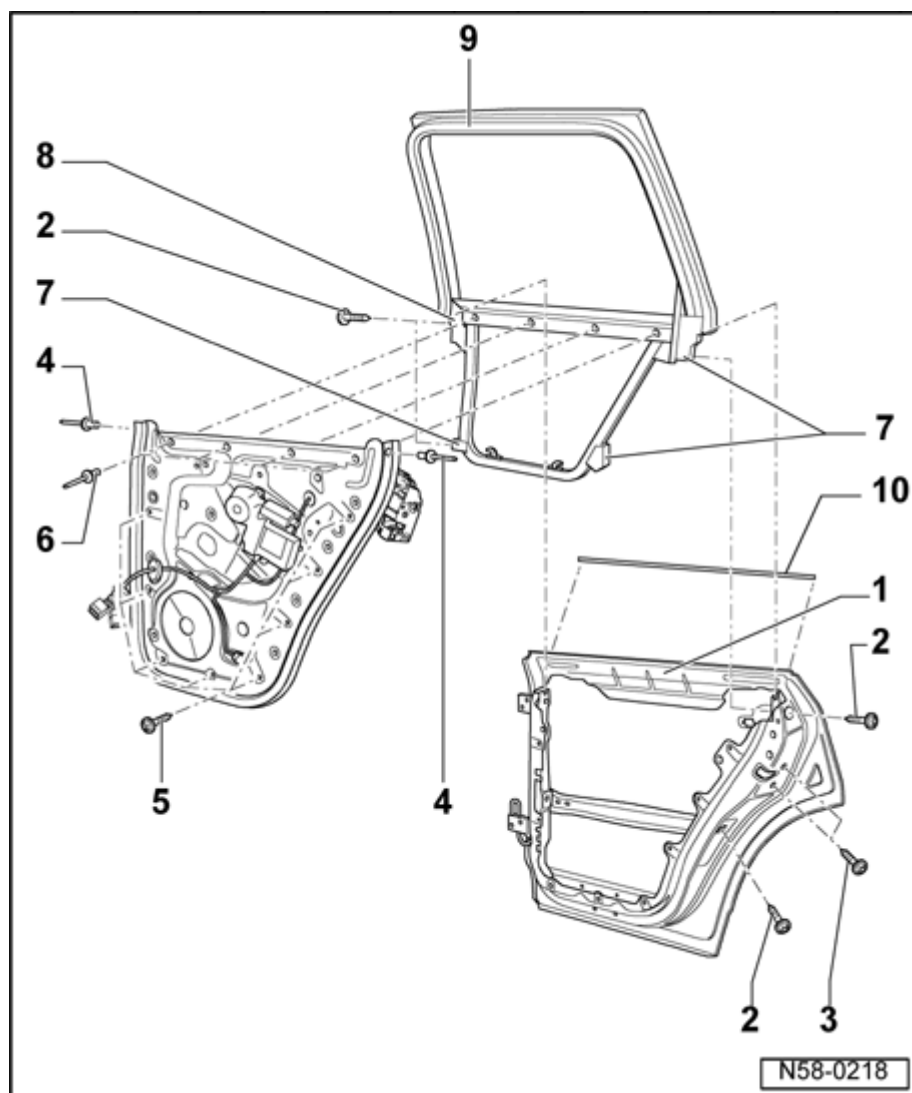

Construction of the Touareg door differs considerably from that of other models.

Entire door consists of outer door panel - **1** - , assembly carrier - **6** - and window frame - **9** - . When assembly carrier and window frame are joined together, it is referred to as a subframe.

Assembly carrier and window frame cannot be completed individually. Only when they are combined to form the subframe can individual parts be installed.

Individual window frame components, assembly overview

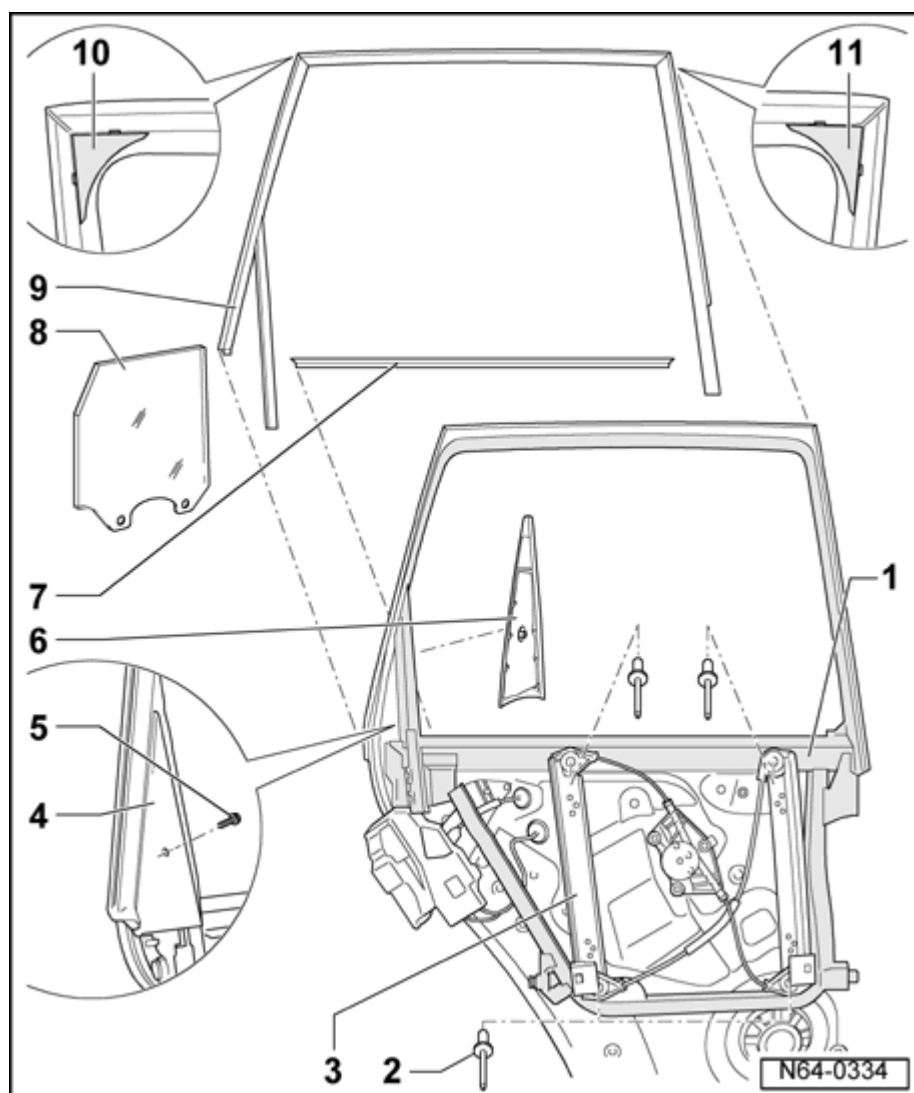

- **Window frame**

- Riveted to assembly carrier in the illustration.

- **Pop rivet**

- Qty. 4
 - Join window regulator to window frame

- **Window regulator**

- **Trim**

- The outer trim is secured by a bolt

- **Bolt**

- **Trim**

- The inner trim is engaged in window frame

- **Window recess seal**

- Installed onto flange

- **Door window**

- Removing ⇒ [64-4, Door window, removing and installing](#)

- **Outer window guide**

- Installed onto flange

- **Cap**

- Pushed between window frame and upper rear window guide

- **Cap**

- Pushed between window frame and upper front window guide

Door window, removing and installing

Removing

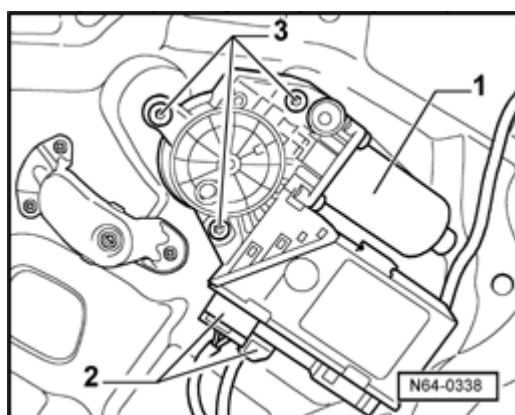

- Remove rear door trim

⇒ [Repair Manual, Body Interior, Repair Group 70, Door trim, removing and installing](#)

- Disconnect connectors - **2** - from window regulator motor - **1** - .
- Unscrew bolts - **3** - and remove window regulator motor.

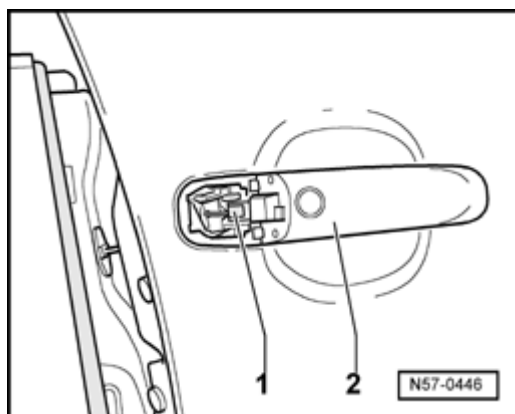

- Remove lock cylinder housing ⇒ [57-1, Lock cylinder housing, removing and installing](#)
- Unclip clip - **1** - from door handle - **2** - .

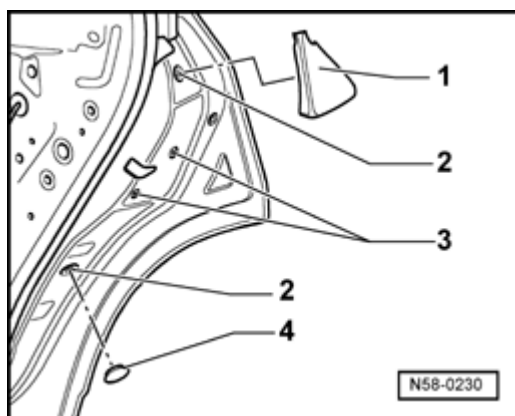

- Pry off caps - **1** - and - **4** - .
- Remove window frame bolts - **2** - .

Torque specification: 20 Nm

- Remove bolts - **3** - for door lock.

Torque specification: 8 Nm

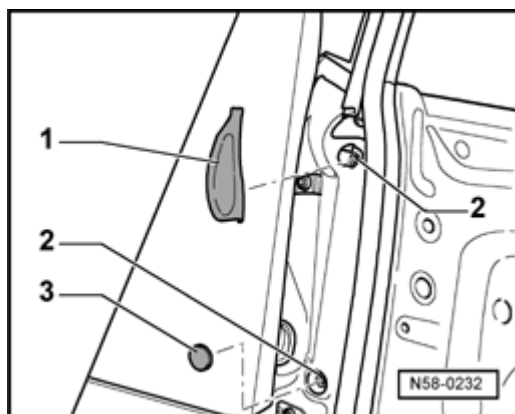

- Pry off caps - **1** - and - **3** - .
- Disconnect boot from B-pillar and disconnect connectors.
- Guide boot and connectors through opening in outer door panel.
- Remove window frame bolts - **2** - .

Torque specification: 20 Nm

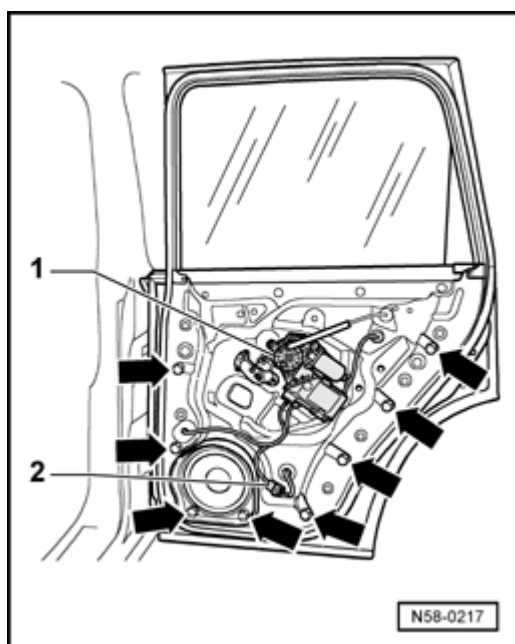

- Disconnect connector - **2** - and guide through opening in assembly carrier.
- Remove bolts - **arrows** - .

Torque specification: 8 Nm

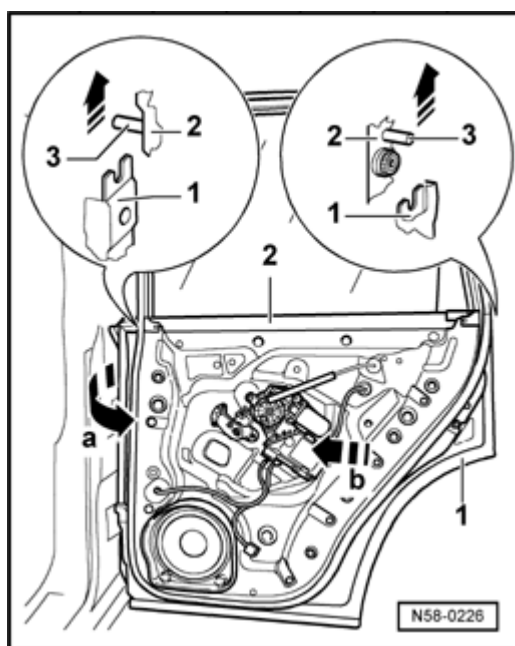

- Pull front part of subframe slightly away from outer door panel - **arrow a** - .
- Be careful to guide the wiring as well.
- Pull subframe out of outer door panel toward hinge side - **arrow b** - .
- When doing this, make sure that door lock does not catch in outer door panel.

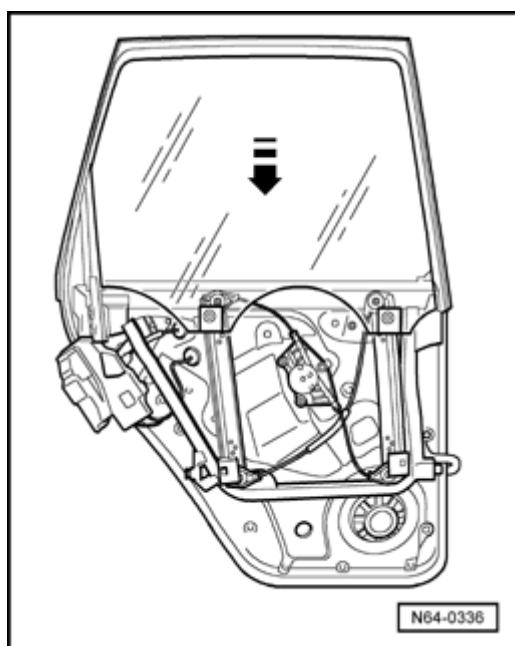

- Lower window by hand in direction of - **arrow** - to lower stop.

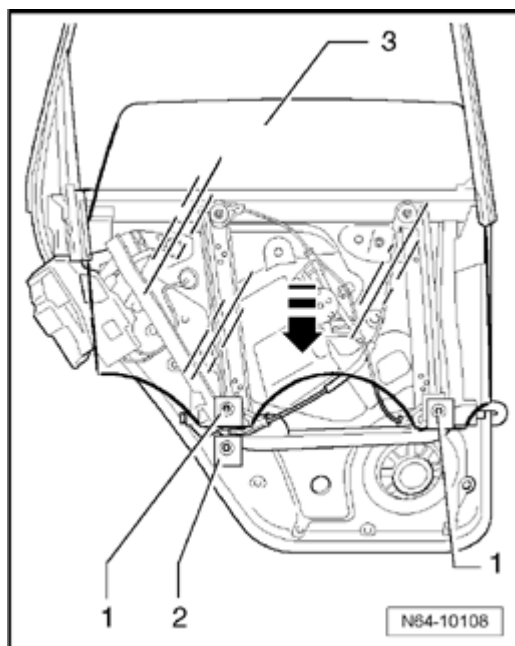

- Remove both bolts - **1** - from securing elements - **2** - on door window - **3** - .
- Fold open both securing elements - **2** - .
- Lift door window - **3** - out of securing elements - **2** - and pull the door window - **3** - downward in direction of - **arrow** - out of window guide.

Installing

Note:

- *Rubber buffer - **3** - is supplied with new window regulator in a plastic bag.*

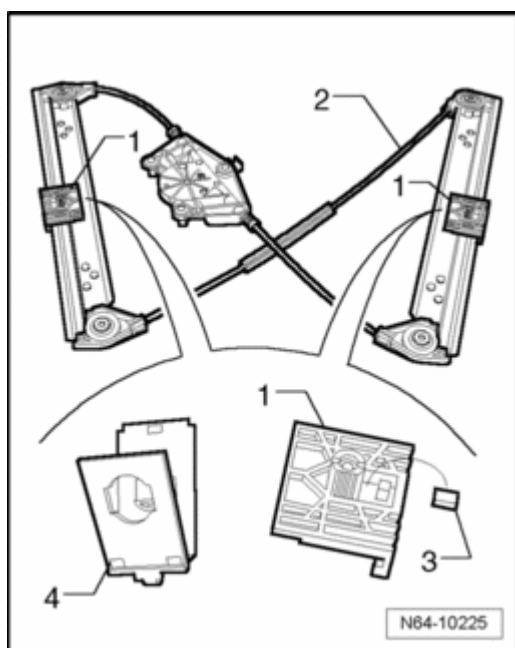

- Before inserting mounting elements - **4** - of door window, be absolutely sure that rubber buffers - **3** - are inserted into mounts - **1** - of window regulator - **2** - .

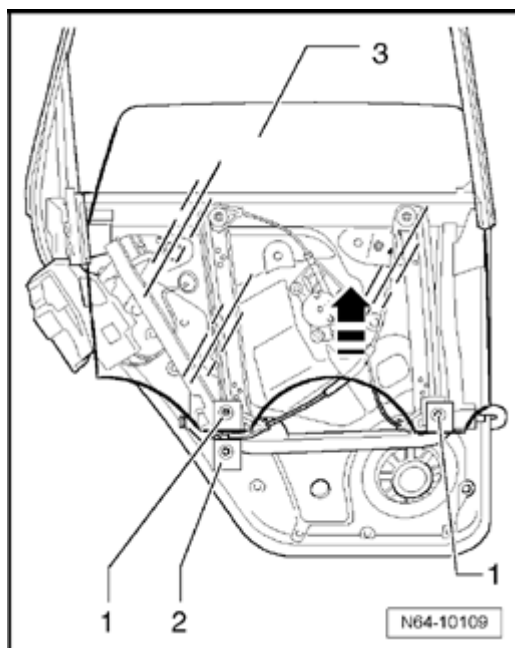

- Guide door window - **3** - into window guide - **3** - and place door window into securing elements - **2** - .
- Install bolts - **1** - and push door window - **3** - to upper stop by hand in direction of - **arrow** - .
- Tighten bolts to specified torque of 3.3 Nm.

Then, continue in reverse order of removal.

- Before installing door trim, check function of door window.

Window regulator, servicing

Removing

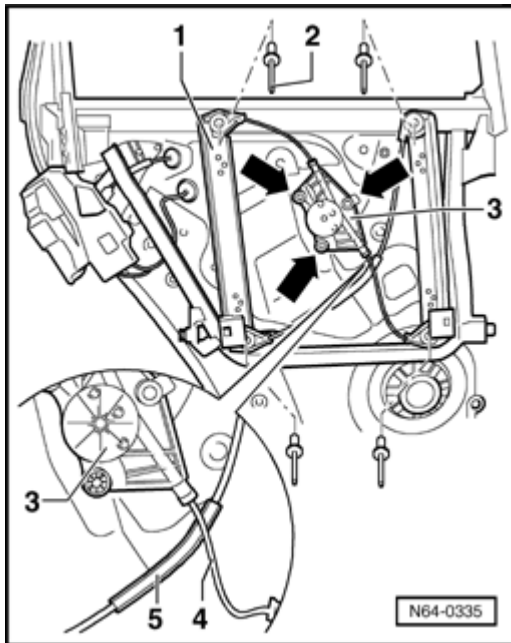

- Remove rear door trim

⇒ [Repair Manual, Body Interior, Repair Group 70, Door trim, removing and installing](#)

.

- Remove door window ⇒ [64-4, Door window, removing and installing](#)

- Drill out the four pop rivets - **2** - of the window regulator - **1** - .

- Pry crank mechanism - **3** - out of the three locking tabs - **arrows** - in assembly carrier.

- Remove window regulator - **1** - from window frame.

Installing

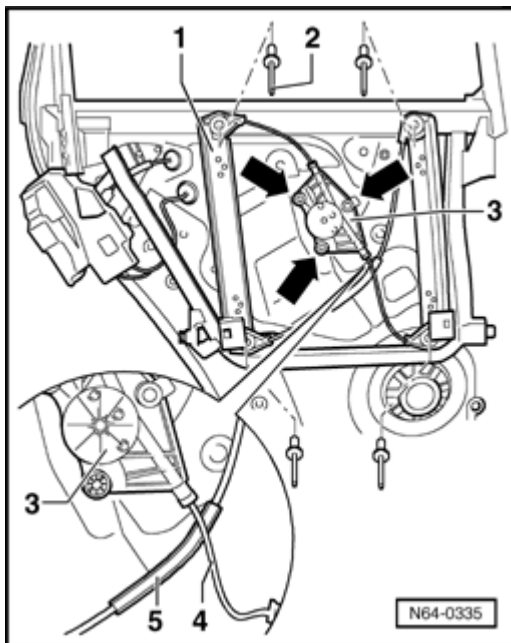

- When installing window regulator - **1** - , make sure that jacketed Bowden cable - **5** - lies between window frame and unjacketed Bowden cable - **4** - .

Then, continue in reverse order of removal.

- Before installing door trim, check function of door window.

Window regulator motor, removing and installing

Removing

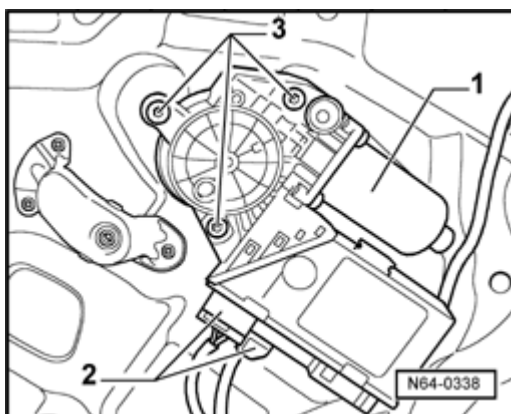

- Remove rear door trim

⇒ [Repair Manual, Body Interior, Repair Group 70, Door trim, removing and installing](#)

- Secure window using adhesive tape to prevent it from falling down.
- Disconnect connectors - **2** - from window regulator motor with control module - **1** - .
- Remove bolts - **3** - and remove the window regulator motor with control module - **1** - from assembly carrier.

Installing

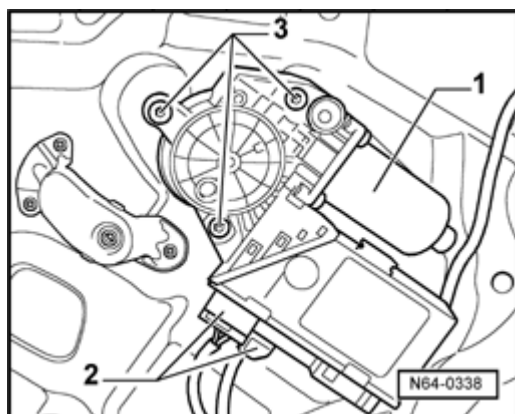

- Install the window regulator motor with control module - **1**
- and connect the connector - **2** - .
- Tighten bolts - **3** - for window regulator motor to torque setting 3.5 Nm).
- Raise the window regulator up and down to the limit stops, twice. With that, the window regulator is functional and the window pinch protection is activated.

Then, continue in reverse order of removal.

- Before installing door trim, check function of door window.