



COROLLA

2005

Pocket Reference Guide





moving forward ▶

2005 Corolla

This *Pocket Reference Guide* is a summary guide for basic vehicle operations. It contains brief descriptions of fundamental operations so you can locate and use the vehicle's main equipment quickly and easily.

The *Pocket Reference Guide* is not intended as a substitute for the *Owner's Manual* located in the vehicle's glove box. We strongly encourage you to review the *Owner's Manual* and supplementary manuals so you will have a better understanding of the vehicle's capabilities and limitations.

Your dealership and the entire staff of Toyota Motor Sales, U.S.A., Inc., wish you many years of satisfied driving in your new Corolla.

! A word about safe vehicle operations

This *Pocket Reference Guide* is not a full guide to Corolla operations. Every Corolla owner should review the *Owner's Manual* that accompanies this vehicle.

Pay special attention to the boxed information highlighted in yellow throughout the *Owner's Manual*. Each box contains safe operating instructions to help you avoid injury or equipment malfunction.

All information in this *Pocket Reference Guide* is current at the time of printing. Toyota reserves the right to make changes at any time without notice.

TABLE OF CONTENTS

Item	Page no.
OVERVIEW	
Engine compartment	7
Fuel tank door opener and cap	6
Hood release lever	6
Indicator symbols	4-5
Instrument cluster	4-5
Instrument panel	2-3
Trunk release lever	6
FEATURES/OPERATIONS	
Air conditioning/Heating	16
Audio	14-15
<i>Auto lock functions-programmable¹</i>	8
Automatic transmission	9
Clock	15
Cruise control	17
Cup holders	17
Door locks-Power	12
Engine immobilizer	13
Light-Interior and instrument panel	8
Keyless entry	8
Lights & turn signals	12
Manual transmission	9
Moonroof	11
Parking brake	11
Power outlets	17
Seat adjustments-Front	10
Seat adjustments-Rear	10
Seats-Head restraints	10
Tilt steering wheel	11
Windows-Power	13
Windshield wiper & washer	13
SAFETY AND EMERGENCY FEATURES	
Airbag-Supplemental Restraint System	19-20
Doors-Child safety locks	18
Seat belts	18
<i>Seat belt warning system</i>	18
Seat belts-Shoulder belt anchor	18
Spare tire & tools	21
Tire Pressure Warning System	19
Trunk-Internal release handle	21
VSC (Vehicle Stability Control)	19

¹ Programmable by consumer

OVERVIEW

Instrument panel

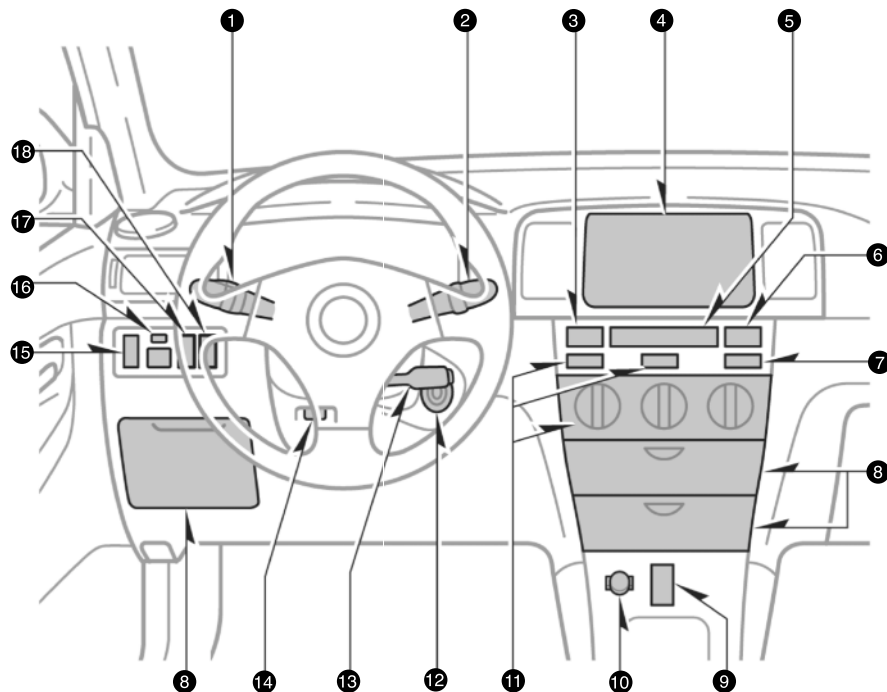

- ❶ Headlight, turn signal and front fog light* controls
- ❷ Wiper and washer controls
- ❸ Emergency flasher switch
- ❹ Audio
- ❺ Clock
- ❻ Front passenger occupant classification indicator light/Front passenger's seat belt reminder light
- ❼ Rear window defogger switch
- ❽ Auxiliary boxes
- ❾ "TRAC OFF" (Traction Control "OFF") switch*
- ❿ 12V Power outlet/Cigarette lighter*
- ⓫ Air conditioning*/Heater controls

- ❿ Ignition switch
- ⓬ Cruise control lever*
- ⓭ Tilt steering lock release lever
- ⓮ Interior/Instrument panel light dial
- ⓯ Power rear view mirror control switch
- ⓰ Tire Pressure Warning set switch*¹
- ⓱ Toyota security system*/Engine immobilizer indicator light

*If installed

¹Refer to page 19 and the *Owner's Manual* for more details.

Instrument cluster

CE/LE models

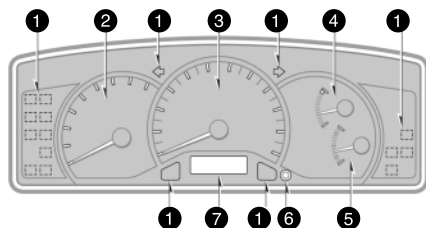

S model

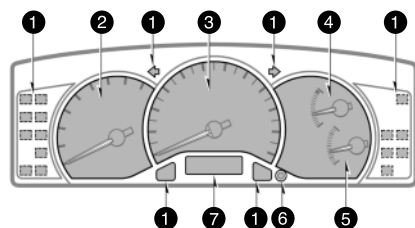

XRS model

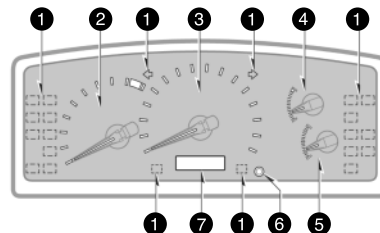

- 1 Service reminder indicators and indicator lights
- 2 Tachometer
- 3 Speedometer
- 4 Engine coolant temperature gauge
- 5 Fuel gauge
- 6 Trip meter reset knob
- 7 Odometer, two trip meters and outside temperature display

Indicator symbols

- BRAKE** Brake system warning light¹
- Driver seat belt reminder light¹
- PASSENGER** Front passenger seat belt reminder light¹
- Battery warning light¹
- Malfunction indicator light¹
- Low fuel level warning light¹
- Low engine oil pressure warning light¹
- ABS** Anti-lock Brake System warning light¹

CAUTION

When the Anti-lock Brake System (ABS) function is in action, you may feel the brake pedal pulsating and hear a noise. In this situation, to let the Anti-lock Brake System work for you, just hold the brake pedal down more firmly. Do not pump the brake, as this will result in reduced braking performance.

- Open door warning light¹
- Airbag SRS warning light¹
- Low Tire Pressure Warning light
- VSC** Vehicle Stability Control/Traction Control warning light¹
- MAINT REQD** Engine oil replacement reminder light¹
- PASSENGER OFF AIRBAG** Front passenger occupant classification indicator
- Headlight low beam indicator light
- Headlight high beam indicator light
- Turn signal indicator lights
- O/D OFF** Overdrive-off indicator light
- Slip indicator light/Traction Control off indicator light
- CRUISE** Cruise control indicator light²

¹For details, refer to "Service reminder indicators and warning buzzers," Section 1-6, 2005 Owner's Manual.

²If this light flashes, refer to "Cruise control," Section 1-7, 2005 Owner's Manual.

Fuel tank door opener and cap

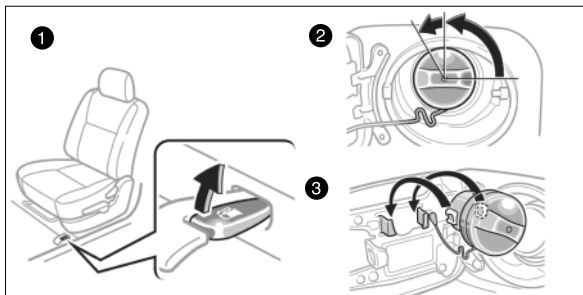

- 1 To open the fuel tank door from driver side seat Pull up on the opener.
- 2 To remove the fuel tank cap Turn the cap counterclockwise 90 degrees, then turn it an additional 30 degrees. Pause slightly before removing it.
- 3 The removed cap can be stored on the fuel tank door.
- 4 To replace the fuel tank cap Turn clockwise until a click is heard. If not tightened enough, Check Engine "CHECK" indicator may illuminate.

Trunk release lever

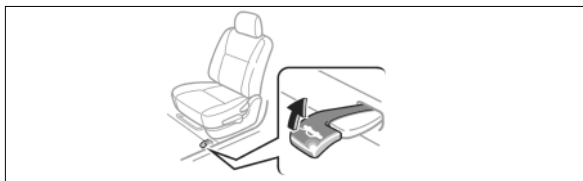

To open the trunk from driver side seat Pull up on the trunk release lever.

Hood release lever

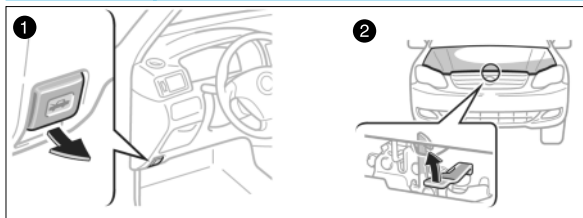

- 1 To release the hood Pull the lever inside vehicle.
- 2 To open the hood Insert finger through the opening between the hood and grill. Pull up on the catch lever inside the compartment and lift the hood.

Engine compartment

CE, LE and S models (1ZZ-FE) engine

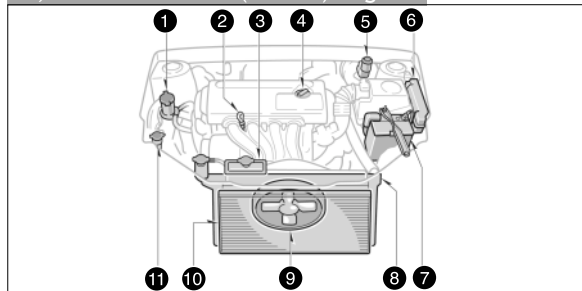

XRS model (2ZZ-GE) engine

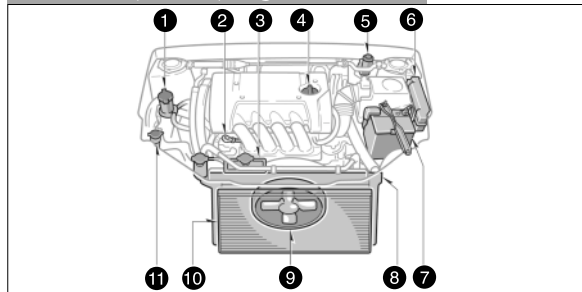

- 1 Power steering fluid reservoir
- 2 Engine oil level dipstick
- 3 Engine coolant reservoir
- 4 Engine oil filler cap
- 5 Brake fluid reservoir
- 6 Fuse block
- 7 Battery
- 8 Radiator
- 9 Electric cooling fan
- 10 A/C Condenser*
- 11 Windshield washer fluid tank

*If installed

Note: Regularly scheduled maintenance, including oil changes, will help extend the life of your vehicle and maintain performance. Please refer to the "Owner's Warranty Information Booklet," "Scheduled Maintenance Guide" or "Owner's Manual Supplement."

FEATURES/OPERATIONS

Auto lock functions-Programmable Automatic Transmission only

Programmable to operate in 4 different modes.
Auto shift-locking only Doors lock when shifting from Park. No unlock function. This is both the default and factory setting.

Deactivate Auto lock function cancelled.

Auto shift-locking and shift-unlocking Doors lock when shifting from park, and unlock when shifting into park.

Auto shift-locking and ignition-unlocking Doors lock when shifting from Park, and unlock when the engine is turned off and ignition key turned to the "ACC" or "LOCK" position.

Refer to the *Owner's Manual* for more information on this feature, and how to change modes.

Keyless entry (if installed)

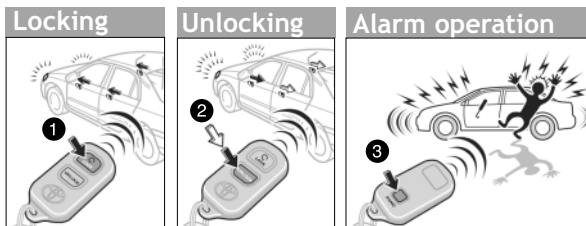

- ① To lock Push "LOCK."
- ② To unlock driver's door Push "UNLOCK" once.
To unlock all the doors Push "UNLOCK" twice.
NOTE: After unlocking, if a door is not opened within thirty (30) seconds, all doors will relock for safety.
- ③ To activate alarm with remote Push "PANIC."

Refer to the *Owner's Manual* for more details.

Light-Interior and instrument panel

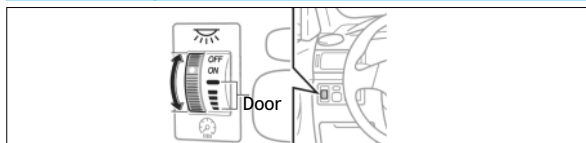

"OFF" Position Interior light off

"ON" Position Interior light on

Door positions Interior light on with door open; adjust instrument panel light intensity by rotating up or down.

Automatic transmission (if installed)

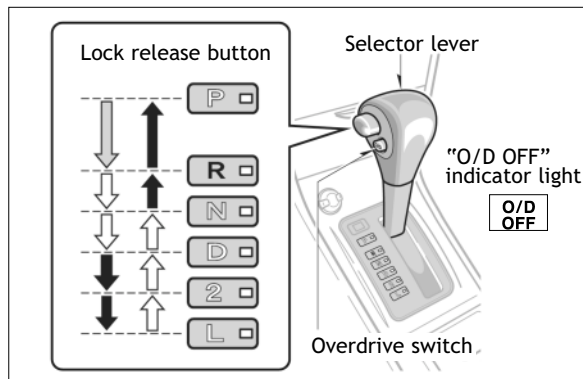

Lock release button

- ↓ With the brake pedal depressed, shift while holding the lock release button in (the ignition switch must be in the "ON" position).
- ↕ Shift while holding the lock release button in.
- ↕ Shift normally.

P	Park Engine starting and key removal
R	Reverse
N	Neutral
D	Drive (See "Overdrive switch" below)
2	Second gear Increased engine braking
L	First gear Maximum engine braking

Overdrive switch

To turn "ON" or "OFF" Depress the overdrive switch to choose either three-speed ("OFF") or four-speed ("ON") operation. During normal driving conditions, always drive with overdrive "ON;" this allows the transmission to shift automatically into four-speed operation at higher speeds, increasing fuel economy. If the indicator light on the instrument cluster is illuminated, overdrive is "OFF."

Manual transmission (if installed)

Corolla is available with optional 5-speed or 6-speed manual transmission. For safety, the engine will not start unless the clutch pedal is FULLY depressed. Refer to the *Owner's Manual* for more details.

Seat adjustments-Front



- ① **Position lever**
- ② **Height crank** Driver side only. Crank up to raise, or down to lower.
- ③ **Seatback angle lever**

Seat adjustments-Rear (if installed)

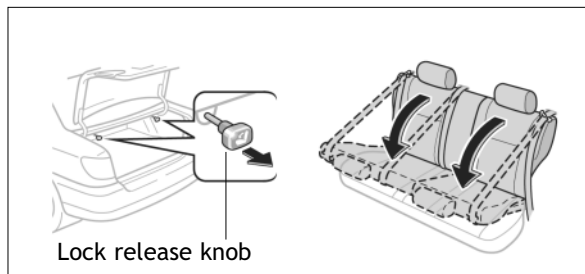

To lower Pull the lock release knob located in the trunk, and lower the seatback.

To raise Pull up the seatback.

Refer to the *Owner's Manual* for more information.

Seats-Head restraints

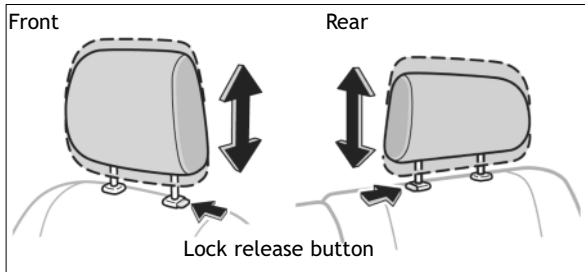

To raise Pull the head restraint up.

To lower Push the lock release button in and push down.

Tilt steering wheel

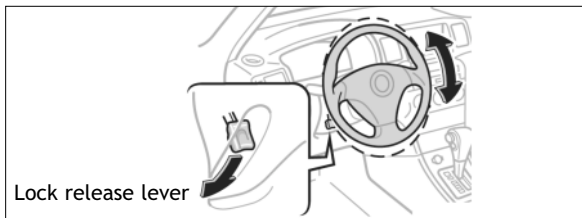

To change the steering wheel angle Hold the steering wheel, push the lock release lever down, set the desired angle and return the lever to its locked position.

Note: Do not attempt to adjust while the vehicle is in motion.

Parking brake

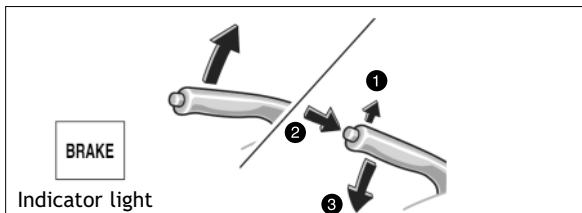

To set Pull the lever.

To release (1) Pull the lever up slightly, (2) press the lock release button and (3) lower.

Moonroof (if installed)

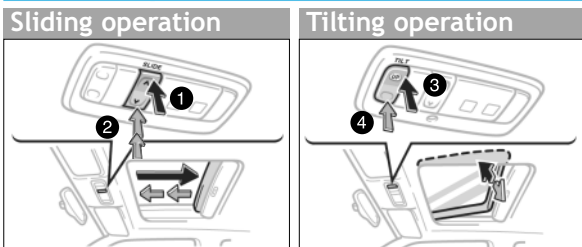

- ① **To open** Push and hold "Λ."
- ② **To close** Push and hold "v," moonroof will close halfway. Push and hold again to completely close.
- ③ **To tilt up** Push and hold "UP."
- ④ **To lower** Push and hold the switch on the opposite side of "UP."

Refer to the *Owner's Manual* for more details.

Door locks-Power (if installed)

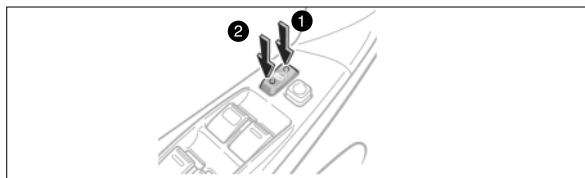

- ① To lock Push down on the front of the switch.
- ② To unlock Push down on the back of the switch.

Lights & turn signals

Headlights

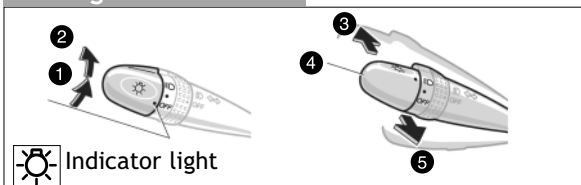

- ① Parking, tail, license plate, side marker and instrument panel lights Twist the lever knob to position 1.
 - ② Headlights and all of the above Twist the lever knob to position 2.
 - ③ High beams Push the lever forward.
 - ④ Low beams
 - ⑤ High beam flasher Pull the lever toward you.
- Note: Daytime running light system***
Automatically turns on the headlights at reduced intensity.

*if installed

Turn signals

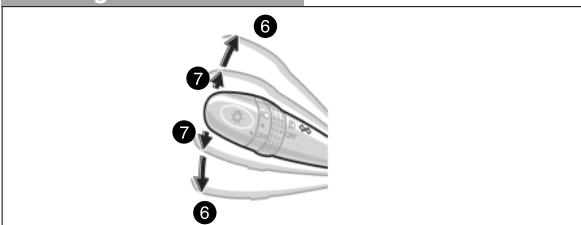

- ⑥ Right or left turn Push the lever up or down.
- ⑦ Lane change Move the lever up or down to position 7 and hold.

Windshield wiper & washer

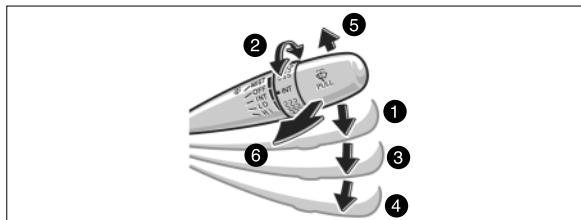

- ① Intermittent speed Push the lever down to position 1.
- ② Interval adjuster* Twist the band to adjust the intermittent speed.
- ③ Slow speed Push the lever down to position 3.
- ④ Fast speed Push the lever down to position 4.
- ⑤ Single wipe Push the lever up to position 5.
- ⑥ Wash and wipe Pull the lever toward you.

* if installed

Windows-Power (if installed)

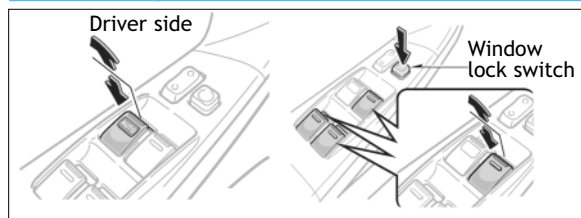

Window operation

To open or close Push down or pull up on the switch.
Automatic down operation (Driver side only) Push the switch completely down and release to fully open. To stop window mid-way, lightly pull up on the switch.

Window lock switch

Push the switch to deactivate the passenger windows.

Engine immobilizer

This is a theft deterrent system. The engine will start only when the electronic code in the key's transponder chip corresponds to the registered ID code for the vehicle. Please note that key replacement can be expensive. Refer to the *Owner's Manual* for more details.

Audio

Type 1

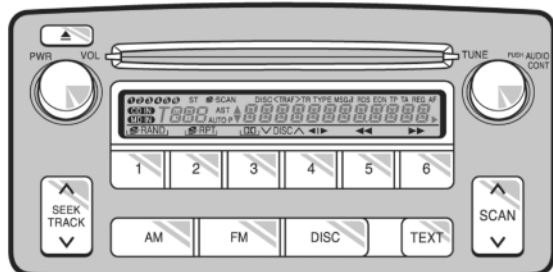

*Functions for buttons 1-6 are indicated above each button on LCD.

Type 2

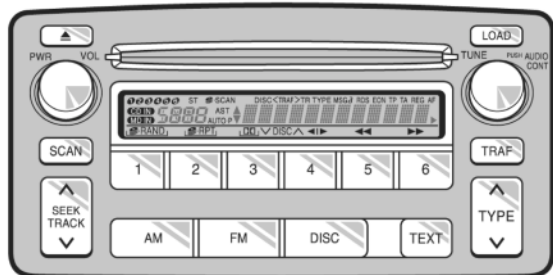

*Functions for buttons 1-6 are indicated above each button on LCD.

BASIC OPERATION

To turn on the audio system Push "PWR·VOL," "AM," "FM" or "DISC."

To turn off the system Push "PWR·VOL."

To adjust the volume Turn "PWR·VOL."

To adjust tone and balance Push the "TUNE·AUDIO CONT" knob. The mode changes with each push in succession from Bass, Treble, Fade, Balance. Turn the knob right or left to adjust each mode.

RADIO

To select a station Push either side of "SEEK/TRACK."

To scan for stations Push "SCAN." Push and hold to scan preset stations. Push again to hold selection.

To select the band Push "AM" or "FM."

To preset a station Tune in the desired station and press a preset button (1-6) until you hear a beep.

To select a preset station Push desired preset button (1-6).

Type 2 only is equipped with ...

- 1 **RDS (Radio Data System) Text Display** Push "TEXT" to receive information transmitted from Radio Stations.

CD PLAYER

The CD Player is intended for use with 4.7 inch discs ONLY. Refer to your Owner's Manual for more details.

To play Insert a compact disc.

To select a track Push either side of "SEEK/TRACK."

To scan tracks on a disc Push and hold "SCAN." Push again to hold selection.

To eject a compact disc Push "▲."

To view CD text Push "TEXT" to display disc information.

Type 2 only is equipped with ...

- 1 **CD Changer**
To load one disc Push "LOAD" and insert 1 disc.
To load multiple discs Push and hold "LOAD" until you hear a beep. Insert one disc. Shutter will close and then re-open for next disc.

Refer to the *Owner's Manual* for more details.

Clock



To reset the hour Push the "H" button.

To reset the minutes Push the "M" button.

Air conditioning (if installed)/Heating

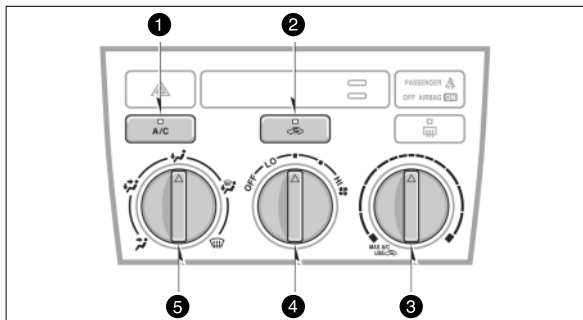

- 1 **"A/C" switch*** Push to turn air conditioning on/off. Turn to "MAX A/C," and use "🌀" for maximum cooling. Indicator light is on when recirculating.
- 2 **Air intake selector** Fresh air (indicator light "ON") or recirculated air (indicator light "OFF").
- 3 **Temperature selector** Turn right to increase, or left to decrease the desired temperature inside the vehicle.
- 4 **Fan speed selector** Turn right to increase, or left to decrease fan speed.
- 5 **Air flow selector** (See "To select air flow vents" below)

*If installed

To select air flow vents

Turn the air flow selector to select one of the following:

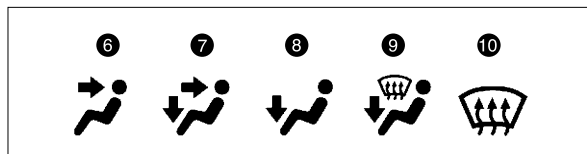

- 6 **Instrument panel**
- 7 **Floor and panel**
- 8 **Floor¹**
- 9 **Floor and windshield²**
- 10 **Windshield²**

¹Use fresh air "🌀" indicator "OFF" to reduce window fogging.

²Will only work in fresh air mode "🌀" indicator "OFF" to clear windshield quickly.

Refer to the *Owner's Manual* for more details.

Cruise control (if installed)

Turning system on/off

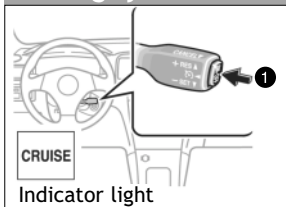

Setting a speed

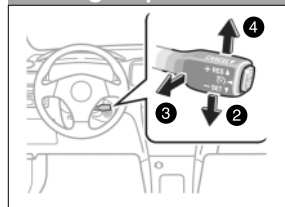

- 1 **To turn the system "ON" or "OFF"** Push the button.
- 2 **To set a speed** Bring the vehicle to the desired speed. Push the lever down toward "-SET."
- 3 **To cancel the set speed** Pull the lever to "CANCEL." The set speed may also be cancelled by either of the following :
 - Depress the brake pedal.
 - Depress the clutch pedal (Manual Transmission)
- 4 **To resume set speed after cancel** Push the lever up toward "+RES" after reaching a speed of 25 mph. XRS model only: once vehicle speed drops below 25 mph, set speed will not resume.

NOTE: To raise set speed, push up toward "+RES." To lower set speed, push down toward "-SET."

Refer to the *Owner's Manual* for more details.

Cup holders

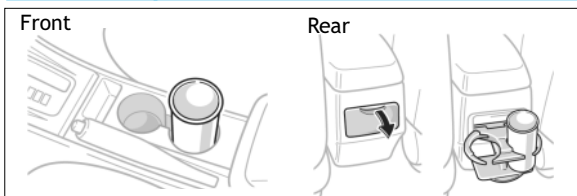

Power outlets

Shifter area (12V)

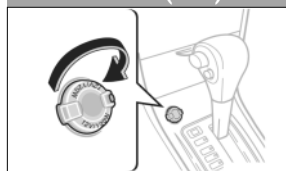

Center console box (12V)



Designed for car accessories. Key must be in the "ACC" or "ON" position to be used.

SAFETY AND EMERGENCY FEATURES

Doors-Child safety locks

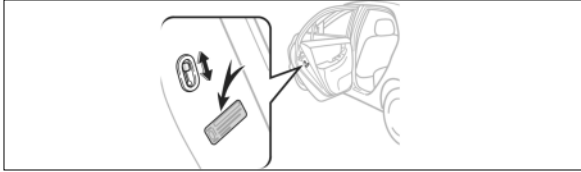

To lock the inside handle Move the lever to “LOCK,” allowing the door to be opened only from the outside.

Seat belts

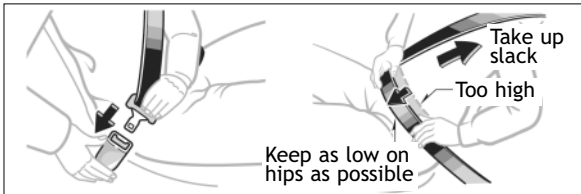

If belt is fully extended, then retracted even slightly, it cannot be re-extended beyond that point, unless fully retracted again. This feature is used to help hold child restraint systems securely.

To find more information about seat belts, and how to install a child restraint system, refer to the *Owner's Manual*.

Seat belt warning system

If you don't fasten your seat belt, and the vehicle reaches a speed of over 5 mph, an alarm will sound to remind you to fasten your seat belt. For safety, please wear a seat belt at all times.

Seat belts-Shoulder belt anchor

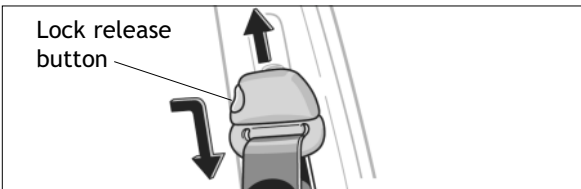

To raise Slide the anchor upward.

To lower Squeeze the lock release button and slide the anchor downward.

VSC¹ (Vehicle Stability Control) (if installed)*

Helps provide comprehensive control of the Anti-lock Brakes, Brake-Assist², Traction Control, engine control and other systems. This system helps maintain control of the vehicle under adverse conditions.

¹Vehicle Stability Control (VSC) is an electronic system designed to help the driver maintain vehicle control under adverse conditions. It is not a substitute for safe driving practices. Factors including speed, road conditions and driver steering input can all affect whether VSC will be effective in preventing loss of control.

²Brake-Assist is designed to help the driver take full advantage of the benefits of ABS (Anti-lock Brake System). It is not a substitute for safe driving practices. Braking effectiveness also depends on proper brake-system maintenance and tire and road conditions.

Tire Pressure Warning System (if installed)*

Designed to provide warning when tire pressure of any one of the tires is critically reduced while the vehicle is moving. It must be re-initialized by pushing and holding the “” button if indicator light blinks once every 3 seconds, and/or after replacing or rotating tires or wheels. See page 3 of this guide for switch location.

Airbag-Supplemental Restraint System

The Airbag Supplemental Restraint System (SRS) front, side* and side curtain* airbags are designed to provide further protection for the driver and outboard passenger in addition to the primary safety protection provided by the seat belts.

Front passenger occupant classification system
Monitors the load on the front passenger seat, and detects if the seat belt is fastened to determine passenger occupancy and size of passenger, if any.

For the system to correctly determine conditions

- Do not place heavy objects on the front passenger seat.
- Do not attach a seatback table to the front passenger seatback.
- Do not put weight on the front passenger seat by putting your hands or feet on the front passenger seatback from the rear passenger seat.

Please read the following caution boxes, and refer to the *Owner's Manual* for more details.

*If installed.

CAUTION

- The driver and front passenger airbag Supplemental Restraint System (SRS) is designed only as a supplement to the primary protection of the seat belt systems of the driver and front passenger. The front seat occupants are particularly susceptible to injury if they do not wear their seat belts; when sudden braking or a collision occurs, they may be thrown forward. To obtain maximum protection in an accident, the driver and all passengers in the vehicle should always wear their seat belts when driving because serious injuries or death can result to unrestrained occupants. For instructions and precautions concerning the seat belt system, see "Seat belts" in the *Owner's Manual*.
- Toyota strongly urges the use of a proper child restraint system on the rear seat that conforms to the size of the child. According to accident statistics, a child is safer when properly restrained in the rear seat than on the front seat.
- Never use a rear-facing child restraint system in the front seat even if the front passenger occupant classification indicator light is "OFF". The force of the rapid inflation of the passenger airbag can cause severe injury or death to a child.
- Unless it is unavoidable, do not install a forward-facing child restraint system on the front seat even if the front passenger occupant classification indicator light is "OFF". If you must install a forward-facing child restraint system in that the front seat, move the seat as far back as possible.
- Make sure you have complied with all installation instructions provided by the child restraint manufacturer and the system is properly secured.
- Make sure the front passenger occupant classification indicator light indicates "ON" when using the seat belt extender for the front passenger seat. If the indicator light indicates "OFF," disconnect the extender tongue from the seat belt buckle, then reconnect the seat belt. Reconnect the seat belt extender after making sure the indicator light indicates "ON." If you use the seat belt extender while the indicator light indicates "OFF," the front passenger airbag and side airbag on the front passenger side may not activate correctly, which could cause death or serious injury in the event of collision.
- If an adult sits in the front passenger seat, the occupant classification indicator light should indicate "ON." If the "OFF" indicator is illuminated, ask the passenger to sit up straight, well back in the seat, feet on the floor, and with the seat belt worn correctly. If the "OFF" indicator still remains illuminated, either ask the passenger to move to the rear seat, or if that is not possible, move the front passenger seat fully rearward.
- The SRS side and side curtain airbags (optional) are designed to deploy in certain types of severe side impact collisions. In all other collisions, the side impact and side curtain airbags will not deploy. For instructions and precautions, see your *Owner's Manual*.
- Do not lean against the front doors when the vehicle is in use. The side and side curtain airbags inflate with considerable speed and force. Death or serious injury could result.
- Do not modify, cover or replace the surface of the front seats. Such changes could disable the system or prevent the airbags from activating correctly, resulting in death or serious injury.

Spare tire & tools

Tool location

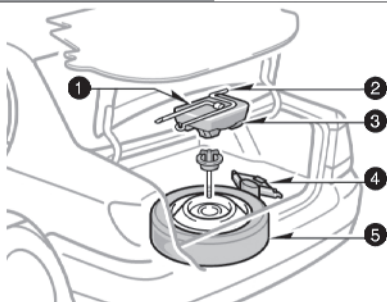

- | | |
|--------------------|--------------|
| 1 Wheel nut wrench | 4 Jack |
| 2 Jack handle | 5 Spare tire |
| 3 Tool holder | |

Removing the spare tire

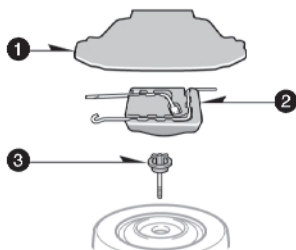

To remove the spare tire

- 1 Raise the luggage compartment floor panel.
- 2 Remove the tool holder and tools.
- 3 Loosen and remove bolt with spacer.

Refer to the *Owner's Manual* for jack positioning and tire changing procedures.

Trunk-Internal release handle

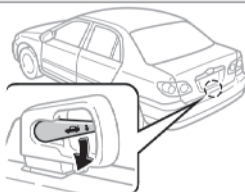

To open the trunk from the inside Pull down the phosphorescent handle on the inside of the trunk.

If you have any questions or comments
please contact the Toyota Customer
Experience Center at 1-800-331-4331, or
visit our informative, interactive Web site at
<http://www.toyota.com>

